

LYSAGHT
THERE IS NO EQUIVALENT

来实钢品

产 品 手 册
Product Line-Up

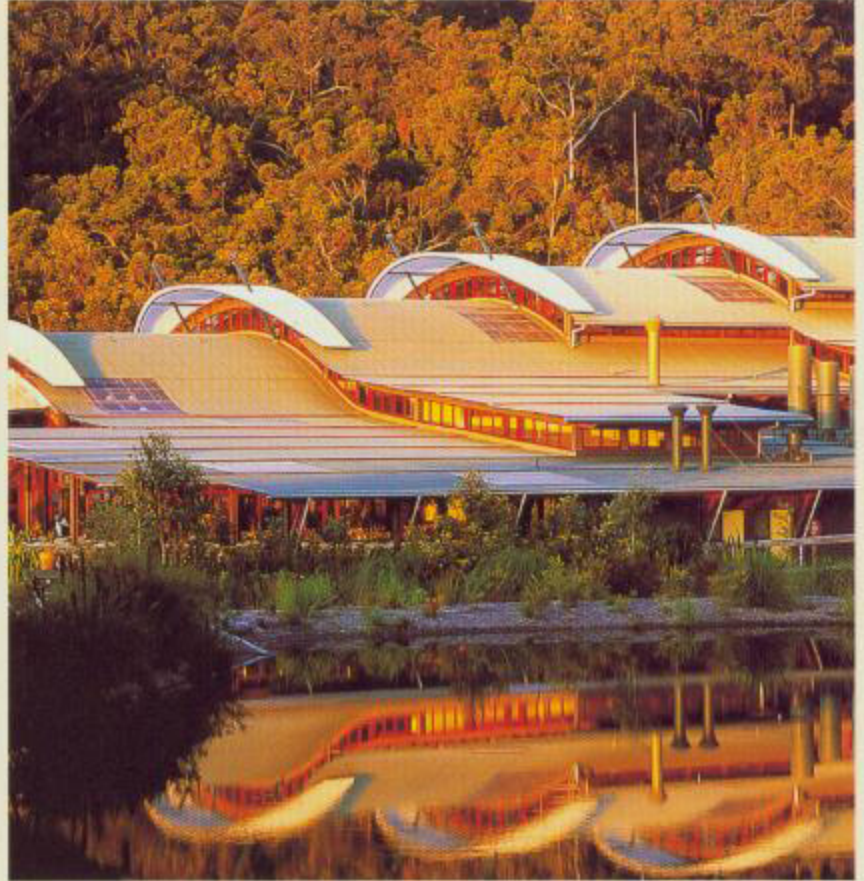

BHP Building Products

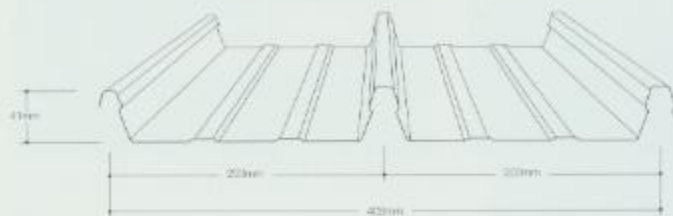

来实KL板是最理想的屋面钢板。41mm高的窄肋不仅加强了钢板的强度,而且具有美观及排水性极佳的特性。来实KL板的最小建议屋面坡度为2°(1/30或3%)。如果条件许可,来实KL板可用于坡度低至1°的屋面。独特的KL65固定座的隐藏式安装系统,使钢板表面没有螺钉穿透。

来实KL板由BHP预涂覆洁面镀锌钢板或本色镀锌高强度钢板滚压而成,其基钢的最小屈服强度为550MPa,材质符合澳大利亚AS1397-G550-AZ150标准,高强度的基钢增加了钢板的跨度,同时减少了支撑檩条的使用数量。

在满足运输条件的情况下,来实KL板的长度一般可以根据项目需求生产,对大型项目亦可提供现场压制。

LYSAGHT KLIP-LOK® is our premium roofing profile. Its 41mm high, but slim ribs provide strength, beauty and maximum rainfall intensity carrying capacity. LYSAGHT KLIP-LOK® is recommended down to a minimum roof pitch of 2° (1 in 30 or 3%). If the purlins and the roof plane are perfectly aligned LYSAGHT KLIP-LOK® can be used for roof slopes as low as 1°. The original KL65 concealed clip installation system, means that no fasteners penetrate the profile.

LYSAGHT KLIP-LOK® is manufactured from BHP's Clean Colorbond® (pre-painted) and Zincalume® (unpainted) steels. The minimum yield strength of the base steel is 550MPa and confirms to Australian Standard AS1397-G550-AZ150. This high tensile steel base gives added spanning ability to the profile, thus reducing the number of purlin supports required.

LYSAGHT KLIP-LOK® is produced to our customers' project length requirements, restricted only by transport limitations. For large projects we have mobile equipment which can produce longer lengths at site.



技术数据 Specifications

钢板总厚度 TCT (mm)	单位面积重量 Mass (Kg/m ²)		非台风区建议最大支撑间距 Maximum Recommended Support Spacings in Non Cyclonic Areas						无支撑悬挑 Unstiffened Overhang
			屋面 Roofs			墙面 Walls			
	镀锌锌 Zincalume®	彩色镀锌 Colorbond®	单跨 Single Span	端跨 End Span	中间跨 Internal Span	单跨 Single Span	端跨 End Span	中间跨 Internal Span	
0.53	5.61	5.66	1500	1800	2100	2000	2200	2400	200
0.65	6.95	7.00	1800	2100	2500	2200	2400	2600	250

* 钢板总厚度指基钢厚度与镀锌层厚度的总和,不包括彩色油漆涂层。TCT refers to total coated thickness of base steel and the al/zn coating. Colorbond® paint film thickness is additional.



• 上海浦东国际机场货运库 Pudong International Airport Cargo Centre, Shanghai



• 上海浦东国际机场配餐中心 Pudong Airport Food & Beverage Service Centre, Shanghai

安装 INSTALLATION

来实KL板通过KL65专用隐藏式固定座与檩条固定。固定座与螺钉作为BHP建筑制品屋面系统的一部分与泛水、收边板及其他零配件等一起配套提供。隐藏式固定方法请参见下图。

LYSAGHT KLIP-LOK® is installed using patented KL65 clips which are secured to purlin supports by self-drilling fasteners. Both clips and fasteners form part of the BHP Steel Building Products roofing supply package together with compatible flashings, trims and other accessories. The accompanying sketch illustrates our concealed fastener concept.

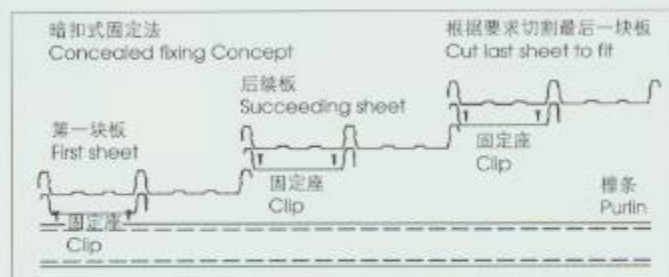

* 来实KL板采用BHP洁面彩色镀锌钢板或本色镀锌钢板滚压而成。LYSAGHT KLIP-LOK® is always produced from BHP Clean Colorbond® or Zincalume® (unpainted) steels.



• 深圳网球中心 Tennis Centre, Shenzhen



• 福建省游泳跳水馆 Provincial Natatorium, Fujian



• 深圳高科技成果交易会展览馆 Hi-Tech Achievements Trading Centre, Shenzhen



• 厦门众达钢铁 Zhongda Steel, Xiamen



• 上海大众新厂区 Shanghai Volkswagen



• 厦门柯达公司 Kodak, Xiamen



• 新加坡集装箱集散地
Keppel Distripark, Singapore



• 香港新机场货运中心
Asia Airfreight Terminal Hongkong



• 澳大利亚布里斯班国际机场
Brisbane International Airport, Australia



• 新加坡住宅群 Brishon Housing Estate, Singapore



• 上海美国学校 American School, Shanghai



普通型
PRESTIGE PLAIN

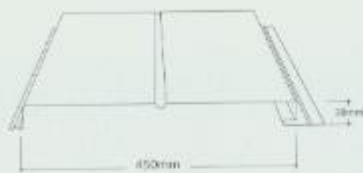

单槽型
PRESTIGE SINGLE FLUTE

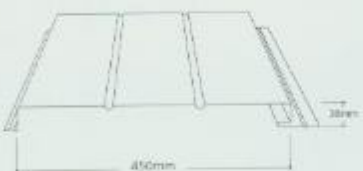

双槽型
PRESTIGE DOUBLE FLUTE

来实PR板是一种独特的以隐藏方式固定的钢板，可用作室内、外墙面板、吊顶、招牌及围栏等。与传统波纹板及单调的平板相比，来实PR板能产生不同风格的立面效果，给客户提供更多的选择。用聚苯或聚氨酯板衬于来实PR板后，既可起到保温隔热作用，又可增加板的刚度，使整体立面平整度更好。来实PR板有多种宽度供客户选择，详情请查询。

LYSAGHT PRESTIGE® PANEL is a distinctive concealed-fastener cladding for exterior & interior walls, ceilings, soffits, fascias and parapets. The use of LYSAGHT PRESTIGE® adds a material selection choice between those of ribbed and completely flat wide panels. Insulation can be achieved by applying PU or PS boards to the back of the panels. This also makes the panels flatter and stronger. Additional widths are available to that shown, on enquiry. Also enquire about maximum sheet length availability.

技术数据 Specifications

钢板总厚度 (不包括油漆层) TCT (mm)	单位面积重量 Mass (kg/m ²)	非台风区建议最大支撑间距 Maximum Recommended Support Spacings in Non Cyclonic Areas		
		单跨 Single Span	端跨 End Span	中间跨 Internal Span
0.85	9.11	1300	1500	1600

• 荷载表请与BHP查询 For the load tables, please refer to BHP.



• 上海俊仕饮料有限公司 Blue Drins Drinking Water, Shanghai



• 美国高级中学 Durango High School

材质 MATERIAL

来实PR板采用BHP洁面彩色镀锌钢板或镀铝锌钢板滚压而成，材质符合澳大利亚AS1397-G300-AZ150标准。

LYSAGHT PRESTIGE® PANEL is produced from BHP's Clean Colorbond® and Zincalume® steels which comply with Australian Standard AS 1397-G300-AZ150.

安装 INSTALLATION

来实PR板以隐藏方式固定，表面不外露螺钉，既可垂直铺设，亦可水平铺设，以达到不同的设计效果。

LYSAGHT PRESTIGE® PANEL is fastened by concealed self-drilling fasteners as illustrated. Panels can be installed vertically or horizontally to suit your aesthetic requirements.

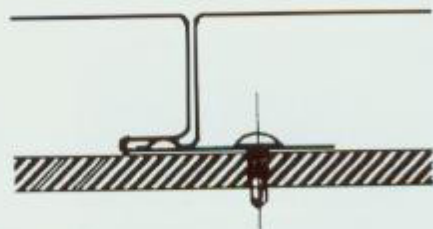

• 美国高级中学 Durango High School



• 上海申美饮料食品有限公司 Shen-Mei Beverage and Food, Shanghai



• 美国高级中学 Durango High School



• 上海奔腾摩托车有限公司 Benteng Motorcycle, Shanghai



• 澳大利亚墨尔本联合航空公司
Federal Airport Corporation Building Melbourne, Australia



• BHP 北京办事处 BHP Beijing Office



• 苏州狮王啤酒公司 Lion Nathan Brewery, Suzhou

来实高强镀锌檩条有C型和Z型两种断面。

来实C型檩条的两翼等宽，适用于各种结构的建筑用途。来实Z型檩条为宽窄翼缘设计，当一根Z型檩条180°翻转时，其宽翼可与另一根同样型号Z型檩条的窄翼通过螺栓固定搭接，这样形成的连续檩不仅可节约材料，而且在弯曲瞬间及剪切力达到极限时，搭接部分固定于钢构件上，其两层檩条翼缘可增强该部分的强度，从而改善整个系统的荷载能力及稳固性。

来实镀锌檩条的安全荷载表是BHP在理论数据基础上，通过与悉尼大学合作，采用其澳洲唯一，世界最大的真空实验设备经过无数次试验得出的。来实高强镀锌檩条是值得客户信赖的产品。

在满足运输条件的情况下，来实C型和Z型檩条的长度一般可以根据项目需求生产，并可按设计在工厂预先打孔。我们配套提供撑杆、拉杆及镀锌螺栓、螺帽、垫圈等。檩条型号参见下表。

LYSAGHT C and Z purlins are roll formed to customers' length requirements and hole-punched to your detail. They are available as a complete package together with bridging pieces, tie rods and galvanised bolt, nut and washer sets. The broad range of sizes is shown below.

A feature of our Z purlin range is one broad and one narrow flange, proportioned so that two sections of the same size, when one is rotated 180°, bolt snugly together, making them suitable for lapping. Structural continuity results in better economy, but lapping provides two thicknesses of material over interior supports, increasing the strength of the sections where bending moments and shears are maximum, improving the load capacity and rigidity of the system.

Our C purlins have equally sized flanges and are suitable in situations where the spans are simply supported and for shorter spans they may be used continuously over two or more spans with the ends butted. This continuity results in reduced deflections compared to simple spans. Symmetrical C purlins are also good for other construction application, such as, rafters, joists, posts and trunking sections.

Our safe load tables are derived from theoretical engineering practice and enhanced by research in conjunction with the University of Sydney, utilising their vacuum test rig, which is the only one of its type in Australia and the largest in the world. You can depend on LYSAGHT HI-Ten® purlins.

C 型 檩 条 C Purlin

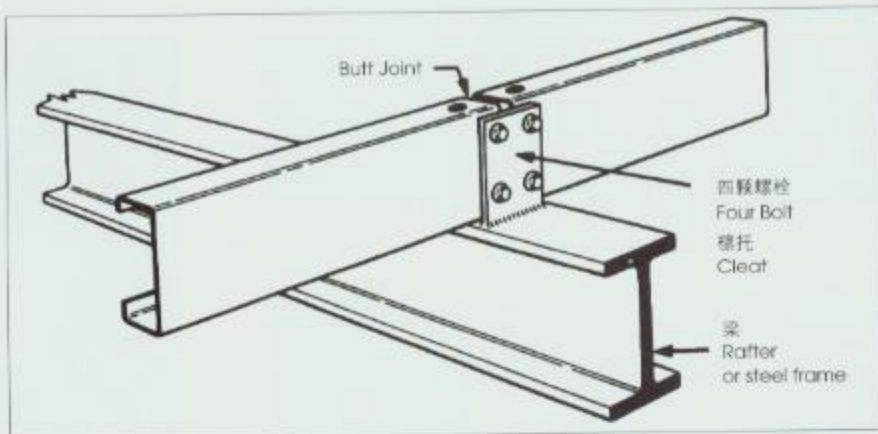
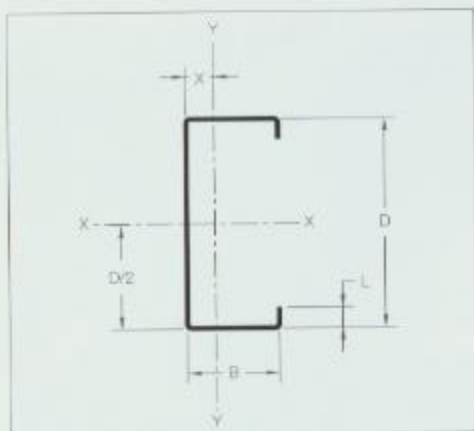

技术数据 Specifications

产品编号 Catalogue Number	尺寸 Dimensions					截面面积 Area mm ²	单位长度重量 Mass per U. Length kg/m	截面惯性矩 Second Moment of Area	
	D	B	L	t	x			I _x	I _y
	mm	mm	mm	mm	mm			10 ⁶ mm ⁴	10 ⁶ mm ⁴
C10015	102	51	13.5	1.5	16.08	322.5	2.58	0.533	0.111
C10019	102	51	14.5	1.9	16.18	408.5	3.25	0.667	0.141
C15015	152	64	15.5	1.5	18.40	442.5	3.54	1.598	0.235
C15019	152	64	16.5	1.9	18.49	560.5	4.46	2.009	0.297
C15024	152	64	18.5	2.4	18.82	708.0	5.62	2.527	0.382
C20015	203	76	15.5	1.5	19.89	555.0	4.44	3.509	0.393
C20019	203	76	19.0	1.9	20.80	712.5	5.68	4.485	0.524
C20024	203	76	21.0	2.4	21.03	900.0	7.15	5.659	0.675
C25019	254	76	18.5	1.9	18.10	807.5	6.43	7.585	0.667
C25024	254	76	20.5	2.4	18.39	1020.0	8.10	9.577	0.716
C30024	300	96	27.5	2.4	24.99	1260.0	10.01	16.919	1.504
C30030	300	96	31.5	3.0	25.74	1590.0	12.60	21.253	1.948
C35030	350	125	30.0	3.0	33.18	1950.0	15.09	35.708	3.799

• 回转半径 Radius of Gyration: $r_g = \sqrt{I/A}$

• 截面模量 Section Modulus: $Z = I/s$ (s-截面最外纤维至相应x轴或y轴的距离, distance to the extreme fibre of the respective axis.)

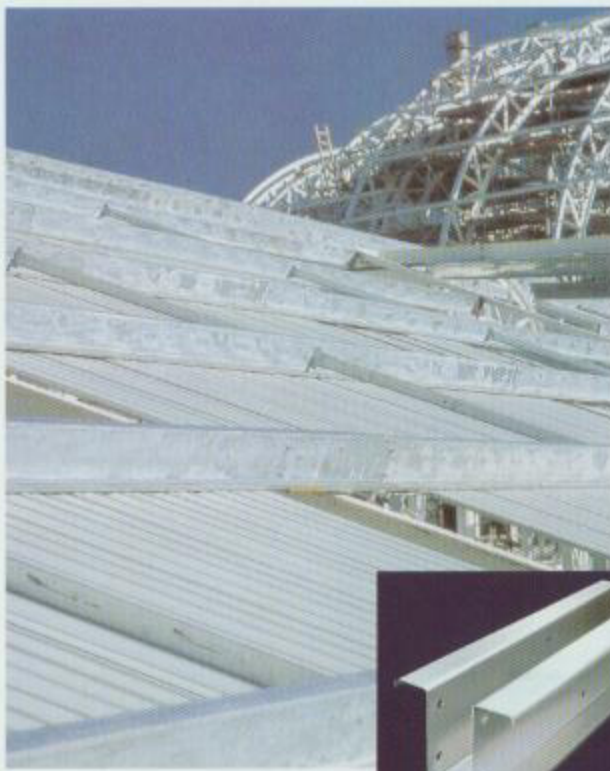

材质 MATERIAL

来实檩条采用BHP生产的冷轧高强度热浸镀锌钢板, 双面镀锌量为 275g/m², 最小屈服强度 450MPa, 材质符合澳大利亚 AS1397-G450-Z275 标准。

来实高强镀锌檩条在室内使用终生无需维护。

LYSAGHT® purlins are always produced from BHP galvanised steel to Australian Standard AS1397-G450-Z275; signifying a minimum yield strength of 450MPa and zinc coating of 275g/m².

Pre-galvanised purlins will mean nil maintenance in most internal applications.



Z 型 檩 条 Z Purlin

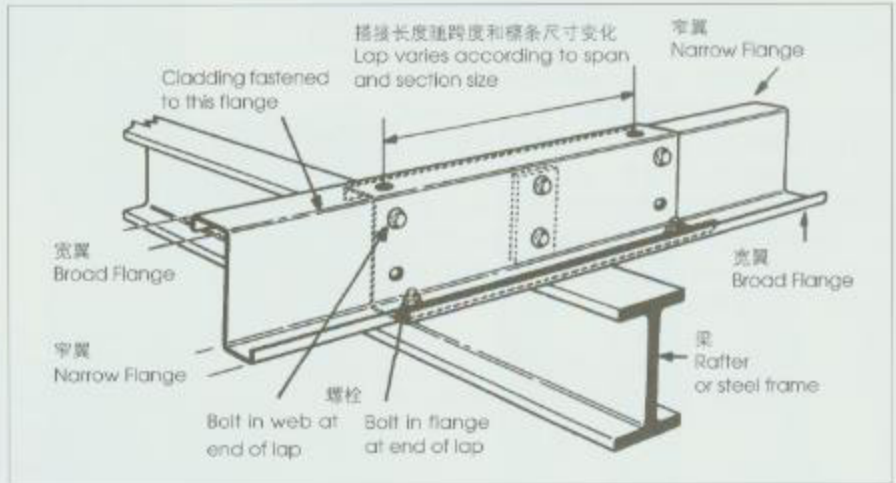
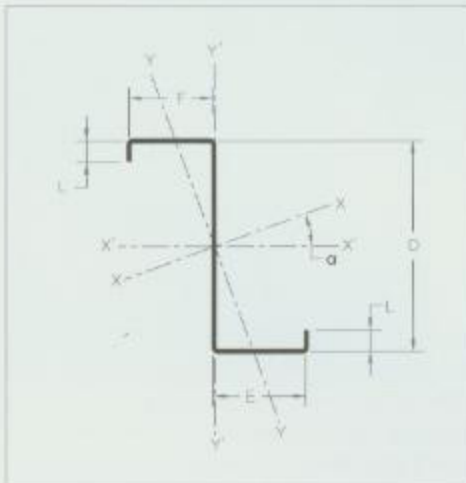

技术数据 Specifications

产品编号 Catalogue Number	尺寸 Dimensions					截面面积 Area	单位长度重量 Mass per U. Length	截面惯性矩 Second Moment of Area				α (Deg.)
	D	E	F	L	t			I _x	I _y	I _x	I _y	
	mm	mm	mm	mm	mm			10 ⁶ mm ⁴	10 ⁶ mm ⁴	10 ⁶ mm ⁴	10 ⁶ mm ⁴	
Z10015	102	53	49	13.5	1.5	322.6	2.58	0.663	0.064	0.533	0.194	27.8
Z10019	102	53	49	14.5	1.9	408.5	3.25	0.833	0.081	0.667	0.248	28.0
Z15015	152	66	61	16.5	1.5	442.6	3.54	1.827	0.144	1.591	0.380	22.0
Z15019	152	66	61	17.5	1.9	560.5	4.46	2.301	0.182	2.001	0.483	22.1
Z15024	152	66	60	19.5	2.4	708.0	5.62	2.906	0.236	2.514	0.627	22.5
Z20015	203	79	74	15.0	1.5	555.0	4.44	3.876	0.253	3.512	0.616	18.5
Z20019	203	79	74	18.5	1.9	712.5	5.68	4.994	0.339	4.496	0.837	19.1
Z20024	203	79	73	21.5	2.4	900.0	7.15	6.324	0.438	5.673	1.089	19.4
Z25019	254	79	74	18.0	1.9	807.5	6.43	8.343	0.408	7.831	0.919	14.7
Z25024	254	79	73	21.0	2.4	1020.0	8.10	10.189	0.488	9.601	1.077	14.3
Z30024	300	100	93	27.0	2.4	1260.0	10.01	18.471	1.027	17.117	2.381	16.2
Z30030	300	100	93	31.0	3.0	1590.0	12.60	23.300	1.332	21.513	3.119	16.6
Z35030	350	129	121	30.0	3.0	1905.0	15.09	39.583	2.516	36.030	6.069	18.0

• 回转半径 Radius of Gyration: $r_y = I_y/A$

• 截面模量 Section Modulus: $Z = I_y/s$ (s-截面最外纤维至相应 x 轴或 y 轴的距离 distance to the extreme fibre of the respective axis)

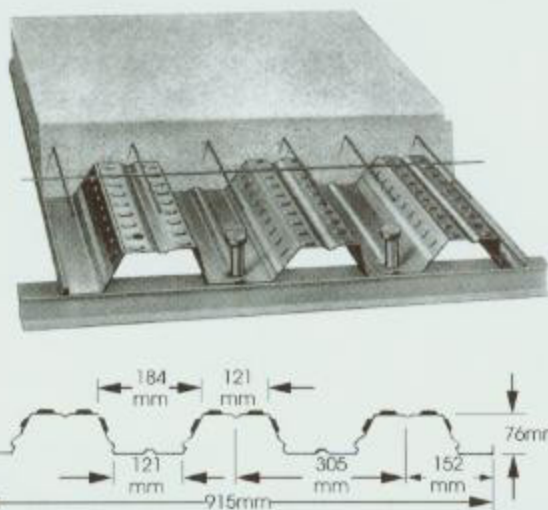
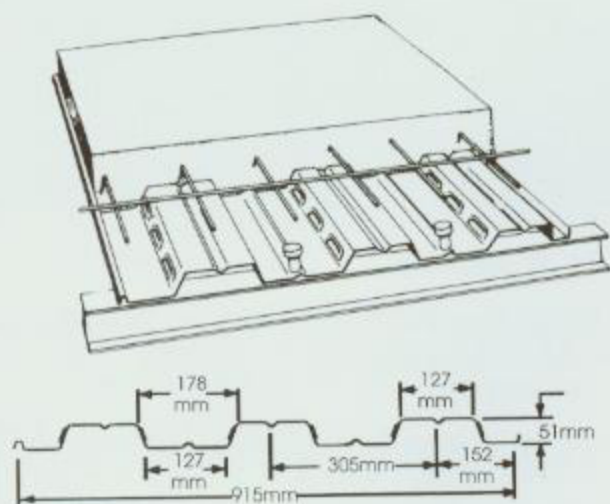

在钢结构工程中,用来实W型结构楼承板承载现浇的混凝土楼板是一种省时经济的方法。

来实W型结构楼承板既可替代混凝土楼板底部受拉筋的使用,又可起到施工时模板的作用。经滚压成型并具有专利的表面压纹使压型钢板与混凝土之间产生最大的机械结合力,同时配以来实W型楼承板加劲肋,进一步增加了压型钢板在组合楼板体系中的承载作用。在组合楼板设计中,来实W型楼承板既在使用阶段代替了受拉筋的作用,又在施工阶段起到了模板的作用,这样在同样满足设计要求的情况下节省了钢筋和混凝土的用量。高强度的来实W型结构楼承板施工快速简捷,能够在短时间内提供坚实的工作平台,在浇筑混凝土后更省去了拆模的麻烦。来实W型结构楼承板基本可以做到无需临时支撑,与传统钢模板或木模板相比,降低了综合造价,也给工地提供了便利的通道及安全干净的施工平面。

来实W型结构楼承板有两种板型,各有四种厚度,足以供设计者结合不同建筑的荷载、跨度要求选择最经济适用的板型。

来实W型结构楼承板符合美国UL耐火极限认证及ICBO标准,并已通过中国公安部天津消防研究所国家固定灭火系统和耐火构件质量检测中心的耐火极限检测,作组合楼承板时无需防火喷涂,大大降低工程造价。

LYSAGHT W structural floor decking® is the time-saving way of constructing suspended concrete floor slabs in steel construction.

LYSAGHT W DECK® can be used as lost formwork or as a composite floor system. The patent embossments, rolled into the profile create the highest bond between concrete and the deck and together with the smaller ribs and flutes enhance our product's composite action and rigidity. Used in composite design, LYSAGHT W DECK®, performs as positive reinforcement as well as permanent formwork, thus providing savings in concrete and reinforcing steel. The fast and simple installation of this high strength product, gives immediate access to a working platform and requires no stripping after concrete curing. Coupled with nil or far less propping compared to strippable formwork, LYSAGHT W DECK® saves considerable construction time which translates to savings in overall construction costs, site accessibility for following trades and site safety.



The availability of 2 profiles in 4 thicknesses enables designers to select the most efficient combination to suit their load and span requirements.

LYSAGHT W DECK® is designed and manufactured to pass USA UL fire rating and ICBO requirements. LYSAGHT W DECK® has also passed the fire rating test at the China Quality Supervision and Test Centre for fixed fire extinguishing systems and fire resisting building components. No sprayed fire treatments are required to the underside of our decking when designed as composite construction which generates additional savings in construction costs.

材质 MATERIAL

来实W型结构楼承板采用BHP镀锌钢板滚压而成,材质符合澳大利亚AS1397-G300-Z275标准(最小屈服强度为300MPa,双面耐腐蚀热浸镀锌量不小于275g/m²),符合美国ASTM A525 G90(1986)标准,超过ASTM A446 Grade C标准。若采用ASTM于1994年新颁布的关于镀锌钢板的材质标准,BHP镀锌钢板则符合或超过ASTM A653 SQ Grade 40 (275) G90标准。

LYSAGHT W DECK® is produced from BHP's ZINCFORM® steel, produced to Australian Standard AS 1397-G300-Z275. (300 MPa minimum yield strength and 275g/m² minimum of corrosion inhibiting hot dip zinc coating) This also meets the specification of ASTM A525 G90 (1986) and surpasses ASTM A446 Grade C. According to new material specifications issued by ASTM in 1994 for galvanised (zinc coated steels), BHP's Zincform®, to the above specification, meets or surpasses ASTM A653 SQ Grade 40 (275) G90.

技术数据 Specifications

板型 Profile	宽度 Width (mm)	板总厚度 TCT (mm)	重量 Weight (Kg/m ²)	1 X10 ⁶ (mm ³ /m)	S ¹ X10 ⁵ (mm ² /m)	S ² X10 ⁵ (mm ² /m)
2W	915	0.75	7.96	0.519	16.02	16.23
		0.90	9.52	0.635	21.34	22.10
		1.20	12.55	0.821	28.76	28.92
		1.50	15.67	1.027	36.02	36.02
3W	915	0.75	8.20	1.050	23.28	25.32
		0.90	9.96	1.281	29.57	30.85
		1.20	13.18	1.721	41.94	41.77
		1.50	16.40	2.160	52.47	52.42

• 荷载表请与 BHP 查询 For the load tables, please refer to BHP.



• 中国保险大厦 (上海)
PICC Building, Shanghai



• 上海城市规划展览馆 City Planning Exhibition Centre, Shanghai



• 上海浦东国际金融大厦
Pudong International Financial Mansion, Shanghai



• 马来西亚吉隆坡双塔
KLCC Petronas Twin Towers, Kuala Lumpur



• 中国工商银行总行大楼 (北京)
ICBC Headquarters Building, Beijing



• 上海金茂大厦 Jinmao Mansion, Shanghai

我们希望本产品手册所展示的优质、耐久的建筑钢品已为广大客户提供了最佳的选择方案。BHP 建筑钢品公司历来重视产品的研究、开发和试验，以确保产品达到各项要求。正因为如此，公司才能以其诚实、严谨赢得广大客户的信赖，在建筑钢品市场始终处于领先地位。来实钢品也正如我们所承诺的，在中国成为物超所值的优质建筑产品。

所有来实钢品在推出使用前，均需经过严格的实验。压型钢板属超薄壁型钢，其受力性能不宜以理论推算，而必须以实验获得。来实系列屋、墙、楼面钢板的所有荷载表均由实验得出，使产品的使用性能得到充分保障。

BHP 建筑钢品公司生产的各种来实品牌的屋、墙面及楼面压型钢板在亚洲及澳洲市场上的年销量已超过千万平米。上百年来，来实钢品一直被尊为建筑钢品的上乘之作。

We hope you have found that this catalogue of high quality, long lasting steel building products has provided a solution for your project. Our tradition of market leadership through research and testing gives you the assurance that you are using products from a company of integrity. By doing what we say we and our products will do, we illustrate why the LYSAGHT® range of steel building products are the best value for money in China.

All products are fully tested before being released to the market as the accompanying photographs show. Roll-formed steel profiles are produced from thin steels and therefore load capacities should not be extrapolated from other thicknesses or shapes. All of our load tables and data have been prepared using actual test data thus giving assurance of performance.

BHP Steel Building Products produce and supply approximately 10 million m² of roof, wall and floor decking per annum throughout Asia and Australia. All LYSAGHT® brand profiles - over a century of recognition.



- 传统气囊实验法，压力无法达到板肋
Airbag does not allow pressure to be applied to ribs



- BHP 新式气液实验法使压力均匀施于整个压型板上，包括板肋。
BHP new pressurized air chamber applies pressure uniformly over entire profile including ribs



- 三层立体车库实验，钢楼板的防火试验
Fire test of floor decking on a three floor car parking garage.



- 在海边进行的彩色钢板暴露实验
Prepainted steel weathering test by the sea



- 在实验室进行的彩色钢板加速耐候实验
Prepainted steel accelerated weathering test in laboratory.



- 压型板受力实验 Load capacity test of steel profiles

- 一九九五年六月一日朱镕基在北京接见BHP总裁裘杰恩先生
Mr. Zhu Rongji met the Managing Director and CEO of BHP Mr. John Prescott in Beijing on June 1, 1995.



- 一九九七年三月二十九日澳大利亚总理约翰·霍华德先生在上海市副市长赵启正先生陪同下参观BHP建筑钢材上海工厂
Australian Prime Minister John Howard visited BHP Steel Building Products (Shanghai) Ltd. with the Deputy Mayor of Shanghai Municipality Mr. Zhao Qizheng on March 29, 1997.



公司概况 COMPANY PROFILE

BHP公司(全称Broken Hill Proprietary Company Limited)是一家创立于1885年,总部设在澳大利亚的大型跨国公司,主要经营矿业、钢铁及石油三大业务。BHP公司是世界财富500强公司之一,在全世界50多个国家和地区拥有50,000名员工,总资产超过210亿美元,年营业额超过140亿美元。今天,BHP股票在世界主要证券市场上市,在全球拥有30多万名股东。

BHP钢铁公司是板材产品的专家,是国际公认先进钢铁镀层及涂覆技术的领导者。

BHP建筑钢品公司隶属BHP钢铁公司,为澳大利亚及亚洲建筑市场提供优质的压型钢板及配套产品。公司前身系1857年成立于澳大利亚的来实钢品公司。140多年生产和销售压型钢板的经验,使BHP建筑钢品公司发展成为当今世界上最大的压型钢板生产商。早期BHP建筑钢品公司通过其在澳大利亚的生产基地向亚洲出口来实钢品,如今仅亚洲就在9个国家经营着17家压型板工厂。公司经营的来实品牌一直代表着建筑钢品的最高标准,来实钢品因其卓越不凡的品质,在国际市场上享有盛誉,得到了建筑师、工程师和建筑商的一致推崇。

在中国,BHP建筑钢品公司先后于1994年和1995年在上海和广州投资设立了两家压型钢板工厂,分别向北中国和南中国地区提供来实钢品。BHP建筑钢品公司通过其遍布全国的销售和技术网络,为客户提供优质的产品和服务。我们已为中国九百多个项目提供了超过九百万平方米的优质屋、墙面及楼面压型钢板。上海和广州工厂均已通过ISO 9002质量认证,我们能证明我们能做得更好。在中国生产的来实钢品拥有BHP建筑钢品在世界其它地方生产的来实钢品一致的品质标准,所有来实钢品始终采用BHP自产的值得信赖的涂覆钢板,如洁面彩色镀锌(Clean Colorbond®)、镀锌铝(Zincalume®)及高强镀锌钢板等,以满足客户的各种需求。

我们期待着为客户提供最佳的方案和服务。

BHP (The Broken Hill Proprietary Company Limited) is an Australian based global company founded in 1885. BHP's core businesses are Minerals, Steel and Petroleum. The company employs 50,000 people in more than 50 countries. As one of the Fortune 500 companies in the world, BHP has total assets of US\$ 21 billion and operating revenues of US\$ 14 billion. Today, it is listed on major stock exchanges and has more than 300,000 shareholders, worldwide.

BHP STEEL is a specialist in flat products and is regarded as a world leader in the metallic and organic coating of steel.

BHP STEEL BUILDING PRODUCTS is a downstream group of companies.



roll-forming cladding and associated building products for the Australian and Asian construction markets. This group of businesses was formerly known as JOHN LYSAGHT which was established in Australia in 1857. With this over 140 years of experience, BHP Steel Building Products has grown to become the largest coated steel profiler in the world. From its Australian base, BHP Steel Building Products, were early in exporting LYSAGHT® products to Asia. Now the company produces the products at 17 manufacturing centres in 9 Asian countries. The LYSAGHT® brand has always meant a supreme standard of quality in steel building products with no equivalent. That is why the name LYSAGHT®, is highly respected by generations of builders, architects and engineers, internationally.

In China, BHP Steel Building Products have established two manufacturing centres. The first at Shanghai in 1994 and the second at Guangzhou in 1995. This brings the direct supply of custom length LYSAGHT® products to the growth centres of northern and southern China. With a network of sales and technical offices throughout the country, BHP Steel Building Products are geared to service your needs. We have already supplied more than 9 million m² of cladding and structural decking products to over 9 hundred major projects in China. Now with ISO 9002 accreditation, we can now prove that we do it even better. The LYSAGHT® products manufactured in China are produced to the same standards as BHP Steel Building Products use elsewhere throughout the world. They are ALWAYS manufactured from BHP's reliable coated steels, such as CLEAN COLORBOND®, ZINCALUME® and ZINC HI-TEN® steels, depending on your application and choice.

We look forward to providing the best solution for you.



工厂 Factories

上海 Shanghai
上海浦东康桥工业区康桥路 855 号
邮编 201315
855 Kangqiao Road,
Kangqiao Industrial Zone, Pudong,
Shanghai 201315
电话 Tel: 021-58120138
传真 Fax: 021-58121363

广州 Guangzhou
广州经济技术开发区东区宏明路 8 号
邮编 510760
8 Hongming Road, Eastern Section of Guangzhou
Economic & Technological
Development District, Guangzhou 510760
电话 Tel: 020-82239980
传真 Fax: 020-82239022

办事处 Sales Offices

上海 Shanghai
上海徐家汇路 430 号
电力大楼 1205 室 邮编 200025
Room 1205 Electric Power Building,
430 Xujiahui Road,
Shanghai 200025
电话 Tel: 021-64726980
传真 Fax: 021-64722229

北京 Beijing
北京朝阳门外大街 18 号
丰联广场 27 层 邮编 100020
27F, Full Link Square,
18 Chao Yangmen Wai Avenue,
Beijing 100020
电话 Tel: 010-65881800
传真 Fax: 010-65881850

广州 Guangzhou
广州环市东路 371-375 号世界贸易中心大厦
南塔 1208-1209 室 邮编 510095
Room 1208-1209 South Tower,
World Trade Centre, 371-375
Huanshidong Road, Guangzhou 510095
电话 Tel: 020-87784018
传真 Fax: 020-87764208

香港 Hong Kong
香港中环花园道 1 号
中银大厦 29 层
29F, Bank of China Tower,
1 Garden Road, Central,
Hong Kong
电话 Tel: 00852-28402524
传真 Fax: 00852-28402444

苏州 Suzhou
苏州干将路 800 号
长谷金融商业大厦 5 楼 A2 邮编 215005
A2 5F Changgu Financial &
Commercial Centre, 800 Ganjiang Road,
Suzhou 215005
电话 Tel: 0512-5237066
传真 Fax: 0512-5232767

大连 Dalian
大连中山区胜利广场 18 号
大连九州饭店 626 室 邮编 116001
Room 626 Holiday Inn Hotel,
18 Shengli Square,
Zhongshan District, Dalian 116001
电话 Tel: 0411-2641709
传真 Fax: 0411-2641693

深圳 Shenzhen
深圳罗湖区深南东路 5047 号
发展银行大厦 17 楼 F 座 邮编 518001
Unit F, 17F, Development Bank Mansion,
5047 Shennandong Road, Luohu District
Shenzhen 518001
电话 Tel: 0755-2080851
传真 Fax: 0755-2080853

厦门 Xiamen
厦门湖滨北路 28 号
建业大厦 1172 室 邮编 361011
Room 1172 Jianye Building,
28 Hubinbei Road,
Xiamen 361011
电话 Tel: 0592-5119805
传真 Fax: 0592-5119807

武汉 Wuhan
武汉惠济路 15 号长航大酒店 6408 室
邮编 430010
Room 6408 Changhang Hotel,
15 Huiji Road, Wuhan 430010
电话 Tel: 027-82863459
传真 Fax: 027-82421473

青岛 Qingdao
青岛福州路 9 号新世界大厦 819 室
邮编 266071
Room 819 New World Plaza,
9 Fuzhou Road, Qingdao 266071
电话 Tel: 0532-5773983
传真 Fax: 0532-5770444

成都 Chengdu
成都西玉龙街 210 号
成都外贸大厦 1505 室 邮编 610015
Room 1505 Foreign Trade Mansion,
210 Xiyulong Avenue, Chengdu 610015
电话 Tel: 028-6612557
传真 Fax: 028-6612397

福州 Fuzhou
福州五一中路 47 号
铁道大厦 605 室 邮编 350005
Room 605 Railway Hotel,
47 Wuyi Zhong Road, Fuzhou 350005
电话 Tel: 0591-3341958
传真 Fax: 0591-3341968

西安 Xi'an
西安建国路 88 号新兴大厦 702A 室
邮编 710001
Room 702A Xinxing Plaza,
88 Jianguo Road,
Xi'an 710001
电话 Tel: 029-7455109
传真 Fax: 029-7455225

南宁 Nanning
南宁园湖南路 32 号
五矿大厦 12 楼 邮编 530022
12F, Minmetal Building,
32 Yuanhunan Road,
Nanning 530022
电话 Tel: 0771-5884445
传真 Fax: 0771-5884605

昆明 Kunming
昆明拓东路 80 号绿洲大酒店 802 室
邮编 660041
Room 802 Green Land Hotel,
80 Tuodong Road,
Kunming 660041
电话 Tel: 0871-3157462
传真 Fax: 0871-3157734

南昌 Nanchang
南昌省府大院
省林业科技中心大厦 807 室 邮编 330046
Room 807 Mansion of Forestry Science and
Technology Centre, Provincial Government
Compound, Nanchang 330046
电话 Tel: 0791-6281915
传真 Fax: 0791-6281915

公司另在北京、珠海、长沙、重庆、贵阳、海口等地有派驻销售人员。
We also have resident sales in Shenyang, Zhuhai, Changsha, Chongqing, Guiyang, Haikou, etc.

BHP 网址: <http://www.bhp.com>
BHP 建筑钢品网址: <http://www.bhpbldgproducts.com>



本色镀铝锌钢板 UNPAINTED ZINCALUME® STEEL

我们生产的来实钢品均采用享誉世界的BHP涂覆钢板为原料。当客户不需要使用彩色面板时，可采用本色镀铝锌钢板 (Zincalume®)。

镀铝锌钢板是BHP公司的一项国际专利产品，该产品自七十年代向世界市场推广以来，已成为最受欢迎的屋、墙面用钢板。镀铝锌钢板的热浸合金镀层含55%铝、43.5%锌和1.5%硅，有效地结合了钢板的强度、铝的抗腐能力和锌对切口及间隙的牺牲保护能力之优势。

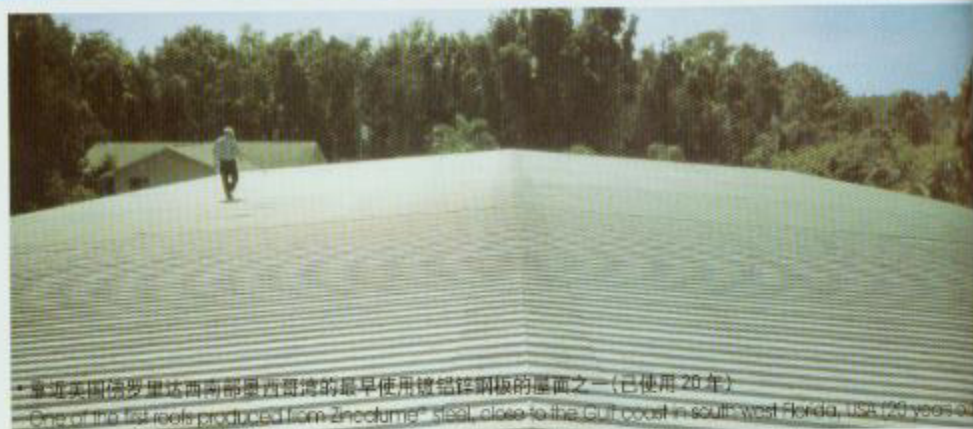

· 靠近美国佛罗里达州西南部墨西哥湾的最早使用镀铝锌钢板的屋面之一 (已使用 20 年)
One of the first roofs produced from zincalume® steel, close to the Gulf coast in south-west Florida, USA (20 years old)

在相似环境下，同等镀层厚度的镀铝锌钢板的寿命是镀锌钢板的四倍左右。镀铝锌钢板是一种价格性能比优越的产品，其成本远低于不锈钢板或铝板，并具有令人赏心悦目的浅银灰色亮丽外表。

照片显示了镀铝锌钢板同镀锌钢板比较时表现的高耐腐蚀性，以及同镀锌钢板比较时，镀铝锌合金层中的锌含量对切口及刮痕处的牺牲保护能力。镀铝锌钢板符合澳大利亚AS1397标准，来实钢品采用的本色镀铝锌钢板为AZ150(双面镀铝锌量不小于150g/m²)。

All of our LYSAGHT® profiles are produced from BHP's world class coated steels. When the cladding application is not required to be coloured, the steel used is Zincalume® steel.

Zincalume® is an international patent owned by BHP. It has become the most popular steel for the manufacture of exposed roof and wall cladding, since it was released into the world market, commercially, in the 1970s. Zincalume® steel combines the strength of steel with the corrosion resistance of aluminium and the sacrificial protection of zinc via its hot dip coated alloy coating of 55% aluminium, 43.5% zinc and 1.5% silicon.

Zincalume® steel offers a service life of 4 times that of galvanised (zinc coated) steel of the same coating thickness exposed in similar environments. It is a 'value for money' product, having a much lower cost to that of stainless steel or aluminium. Zincalume® has a pleasing silver/light grey appearance.

Photographs graphically illustrate the superiority of Zincalume® steel when compared to galvanised (zinc coated) steel. The sacrificial zinc content of the 55% al/zn coating gives cut edge and scratch protection when compared to aluminium coated steels. Zincalume® steel is produced to comply with Australian Standard AS1397. The coating mass used on our Zincalume® LYSAGHT® profiles is AZ150 (150g/m² minimum).



- 实验室加速盐雾试验
Results of laboratory salt spray comparative tests.



镀锌钢板于测试 500 小时后
Galvanized 500 Hours



镀铝锌钢板于测试 500 小时后
Zincalume® 500 Hours



镀锌钢板于测试 2000 小时后
Galvanized 2000 Hours



镀铝锌钢板于测试 2000 小时后
Zincalume® 2000 Hours

- 带刮痕钢板 13 年严重海洋性环境暴露试验
Scratch test after 13 years exposure in severe marine environment.



镀铝锌 Zincalume®

镀锌 Galvanized

镀铝 Aluminum coated

- 贮存了一年海岸区雨水的镀铝锌钢板(左桶)和镀锌钢板(右桶)之比较
Comparison of Zincalume® steel (left) and galvanised steel (right) after one year storage of coastal rainwater.



钢板的野外暴露试验 Colorbond® steel exposure test

随着预涂覆钢板的发展，BHP 不断推陈出新，成为世界涂覆产品先进技术的领先者。来实钢板始终采用BHP最先进的彩色镀铝锌钢板作原材料，为客户提供最好的成型产品。

洁面彩色镀铝锌钢板 (Clean Colorbond®) 最近取代了原先的标准级彩色镀铝锌钢板而成为我们的常规预涂覆产品。它以镀铝锌钢板为基材，加之独特的烤漆配方，经过严格的户外暴露试验后投放市场，不仅保留了标准级彩色镀铝锌钢板所具有的色彩持久、抗涂层龟裂、剥落的

优点，同时具有防止灰尘在建筑物表面吸附的特色，而建筑物上灰尘吸附的现象在中国是相当普遍的。

我们常备有六种标准颜色的洁面彩色镀铝锌钢板，对有充足供货期的大型项目，我们可提供更多的非标准颜色供客户选择。

洁面彩色镀铝锌钢板还有珠光漆级、XPD级 (特殊持久的氟碳漆涂覆系统) 以及 XSE 级 (用于恶劣环境) 等多种彩色涂覆系统供选择。

BHP 彩色镀铝锌钢板符合澳大利亚 AS2728 标准。

Since the evolution of pre-painted steels, BHP has emerged as a world leader in the painting of metallic coated steels. Consequently BHP's Clean Colorbond® steel is always used in the production of our LYSAGHT® profiles. The colours of Clean Colorbond® steel are applied over a Zinalume® steel base, ensuring an even longer service life than unpainted Zinalume® steel. No colours of Clean Colorbond® steel are released to the market until they have undergone and passed extensive outdoor exposure in extreme conditions.

Clean Colorbond® steel has recently replaced Colorbond® XRW steel as our standard pre-painted product. The new paint formulation was designed to overcome dirt staining and retention, so common in China on all building surfaces. Clean Colorbond® steel retains the high colour retention, lack of cracking, peeling and flaking of the Colorbond® XRW it replaces. Now, in addition to warranties for service life to perforation and colour fade, we can offer a warranty against dirt retention on our LYSAGHT® profiles.

At BHP Steel Building Products we hold stocks of Clean Colorbond® steel, in 6 designer colours. For large projects with adequate lead time we can supply from an additional colour range.

The CLEAN formulation is now also available on the Pearlescent, Colorbond® XPD (a premium durability PVF₂ paint system) and Colorbond® XSE (for severe environments) steels, on request.

BHP's Colorbond® steel conforms to Australian Standard AS2728.



镀铝锌色板
Colorbond®



镀锌色板
Prepainted Galv. Steel

• BHP 彩色镀铝锌钢板与彩色镀锌钢板在海岸边暴露 6 年的试验结果比较
The synergy of BHP's Colorbond® with its Zinalume® steel base is graphically illustrated in the comparison with a pre-painted steel on a galvanised steel base in this 6 year in a marine environment exposure.



• 奉堂岛华基邦道制管厂 - 紧靠海边，采用彩色镀铝锌钢板的来实屋，墙面板使用 13 年后仍处良好状态
Huayan Bundy Tubing - After 13 years by sea, LYSAGHT® profiles produced from Colorbond® steel after 13 years are still in good condition.



• 桂林甲山饭店 - 采用彩色镀铝锌钢板的来实屋，墙面板使用 18 年后仍处完好状态
Gullin Jiashan Hotel - LYSAGHT® profiles produced from Colorbond® steel after 18 years are still in excellent condition.

关于 BHP 镀锌彩色压型钢板的使用评价

镀锌钢板自问世以来，在工业和民用建筑中得到了广泛的应用。随着镀锌钢板生产技术的不断进步，镀锌钢板的质量和性能得到了进一步的提高。BHP 镀锌彩色压型钢板，以其优异的性能和美观的外观，广泛应用于各种建筑领域。经过多年的使用，镀锌彩色压型钢板的使用寿命长，维护成本低，且具有良好的耐腐蚀性和抗污染能力。因此，镀锌彩色压型钢板已成为现代建筑的理想选择。



— 中国宝武钢铁集团有限公司 —

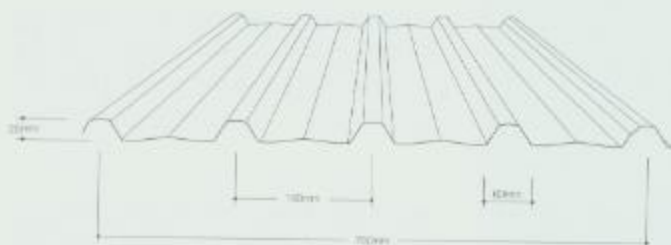

在中国, 我们生产两种不同覆盖宽度的来实TD板。广州工厂生产的板型覆盖宽度为760mm(钢板标准总厚度为0.47mm), 上海工厂生产的板型覆盖宽度为975mm(钢板标准总厚度为0.53mm)。两种板型均具有宽槽、低肋及板跨适中的特点, 是理想的屋面、墙面压型钢板。

来实 TD 板的材质符合澳大利亚 AS1397-G550-AZ150 标准, 采用最小屈服强度为 550MPa 的高强钢滚压而成。这样增大了钢板的跨度, 减少了支撑材料的使用, 从而降低了屋面系统的成本。

独特的公母肋设计杜绝了雨水的毛细渗入, 极佳的密水性使来实 TD 板在暴风雨地区亦被广泛使用。

在满足运输条件的情况下, 来实TD板的长度一般可以根据项目需求生产。

In China, we produce 2 versions of LYSAGHT TRIMDEK®, with different cover widths: 760 mm, ex our Guangzhou factory (0.47mm total coated thickness is the normal thickness). And 975mm, ex our Shanghai factory (0.53mm total coated thickness is the normal thickness). Both profiles feature bold ribs with architecturally pleasing wide pans and are ideal for both, roofing and walling applications.

All LYSAGHT® roofing and walling profiles are produced from 550MPa minimum yield strength high tensile steel to Australian Standard AS1397-G550-AZ150. This allows for a large spanning ability product, thus reducing the frequency of supports, providing a very cost effective roofing system.

The overlapping side ribs are designed to prevent the capillary entry of water and the profile has been fully tested around the world in the highest of rainfall intensity areas.

LYSAGHT TRIMDEK® is produced to our customers' required project lengths, restricted only by transport limitations.

5

技术数据 Specifications

钢板总厚度 TCT (mm)	单位面积重量 Mass (Kg/m ²)		非台风区建议最大支撑间距 Maximum Recommended Support Spacings in Non Cyclonic Areas						无支撑悬挑 Unstiffened Overhang
			屋面 Roofs			墙面 Walls			
	镀锌 Zincalume®	彩色镀锌 Colorbond®	单跨 Single Span	端跨 End Span	中间跨 Internal Span	单跨 Single Span	端跨 End Span	中间跨 Internal Span	
0.47 (广州 Guangzhou)	4.29	4.34	1000	1200	1700	1600	1800	2200	150
0.53 (上海 Shanghai)	4.75	4.79	1400	1600	2000	1700	1900	2300	200



• 安徽芜湖汽车城
Wuhu Automobile, Anhui

- 另有其它厚度供选择, 详情请查询。
Other thicknesses are available, information on request.
- 钢板总厚度指基钢厚度与镀锌镀层厚度的总和, 不包括彩色油漆涂层。
TCT refers to total coated thickness of base steel and the al/zn coating. Colorbond® paint film thickness is additional.
- 来实 TD 板采用 BHP 涂面彩色镀锌钢板或本色镀锌钢板等滚压而成。
LYSAGHT TRIMDEK® is always produced from BHP Clean Colorbond® or Zincalume® (unpainted) steels.



• 上海易初摩托厂
EK Char Motorcycle,
Shanghai



• 成都新成科技园标准厂房 Factory Buildings in Xincheng Technical Zone, Chengdu



• 新加坡体育场 Tampines Sports Stadium, Singapore



• 河南安阳彩色显像管厂房 Anyang Colour Picture Tube Glass Bulb, Henan



• 福建水口电厂 Shukou Power Plant, Fujian



• 北京康明斯发动机公司 Cummins Motor, Beijing



• 上海吴泾热电厂 Wujing Heat and Power Plant, Shanghai



• 澳大利亚住宅 Residence in Australia



• 厦门海沧大桥收费站 Toll Station of Haicang Bridge, Xiamen



• 北京双榆树热电厂 Shuangyushu Heat and Power Plant, Beijing



• 广州依林变压器厂 Elin Transformer Co., Guangzhou



• 新加坡杜邦公司 Du Pont, Singapore

来实高强 TD 板 LYSAGHT TRIMDEK HI-TEN®

安装 INSTALLATION

来实TD板以螺钉穿透方式固定,用于屋面时采用波峰固定,作墙板时通常采用波谷方式固定。固定螺钉对屋面至关重要,BHP通常配套供应与压型钢板具有同等使用寿命及密水性极佳的螺钉,使其与来实钢品共同组成密水持久的屋面体系。

我们还提供与压型板配套的用BHP 洁面彩色镀铝锌钢板和镀铝锌高强度钢板等滚压而成的泛水、收边板及其他零配件。

来实TD板的最小建议屋面坡度为3°(1/20或5%)。

LYSAGHT TRIMDEK® is installed using self-drilling fasteners at the crest of the ribs for roofing and in the valleys for walling. Fasteners are a critical part of roofing and therefore, it is very important to use only compatible and approved fasteners that have been coated to give the equivalent service life of the LYSAGHT® profile. These are available as part of your cladding package from BHP Steel Building Products.

The same compatibility requirements apply to flashings, trims and other accessories. A full range of purpose made flashings and trims produced from BHP CLEAN COLORBOND® and ZINCALUME® steels, also form part of our cladding package.

The recommended minimum roof pitch for LYSAGHT TRIMDEK® is 3° (1 in 20 or 5%).



• 新加坡展览馆 Expo Gateway, Singapore



• 北京首都国际机场候机楼 Capital International Airport Terminal, Beijing

双层板系统 DOUBLE SKIN SYSTEMS

来实TD板作工业建筑的内层板使用亦非常理想。由于室内风载小,受环境腐蚀少,因此我们采用更薄的BHP白色或本色镀铝锌钢板生产来实TD内层钢板。通常内层板安装在檩条的室内一侧。

LYSAGHT TRIMDEK® is an ideal cladding for the internal lining of industrial buildings. We stock thinner BHP coils in white colour, for the production of LYSAGHT TRIMDEK®, for this purpose. Generally this is installed to the internal face of the purlins and girts.

曲面板 CRIMP CURVING

来实TD板可预制成正弧和反弧板,以满足建筑效果的需要,其最小弯曲半径为500mm。

请参见本页的部分来实TD曲面板的工程实例照片。

LYSAGHT TRIMDEK® is also available in pre-curved sheets for architectural features. Both convex and concave curved sheets are available. The radius is as nominated by you, down to a minimum of 500mm.

Some good examples of LYSAGHT CRIMP-CURVED TRIMDEK® are shown on the accompanying pages.



• 深圳体育场 Shenzhen Stadium



• 文莱体育场 Sports Stadium, Brunei



• 厦门市网球馆 Tennis Centre, Xiamen



• 新加坡苹果电脑公司 Apple Computer, Singapore



• 深圳震雄工业园厂房 Zhenxiang Industrial Zone, Shenzhen



• 广州迪森水暖气厂 Devotion, Guangzhou



• 大亚湾宝兴钢厂 Baixing Steel, Dayawan



• 马来西亚候车亭 Waiting Station, Malaysia



• 新加坡美食娱乐中心 Marina South Food & Recreation Centre, Singapore



• 新加坡日本学校 Japanese High School, Singapore



• 上海耀北中学体育馆 Gymnasium of Zhabel High School, Shanghai



• 香港大埔火车站 Tai Po Railway Station, Hongkong